

Retro Morgan Tricycle Owner's Manual

Do not return this product to store! If any parts are missing or damaged, please contact Customer Service by phone at 1-973-218-9233 or e-mail help@morgancycle.com

Model 31201, 31202, 31205, 31212 and 31213

 **CAUTION:** Avoid scratching Tricycle body when assembling the tricycle!

 **Warning:** Adult assembly required!

IMPORTANT SAFETY INFORMATION

- Adult supervision is required! Never leave your Child unattended on or near this product.
- This tricycle does not have a brake. Make sure the child can use the pedal properly to stop.
- Never use near steps, sloped driveways, hills, roadways, alleys, swimming pool areas!
- Never use the tricycle on rough terrain, or for jumping, stunts or other types of abusive riding!
- Do not ride at night or in dark areas! The electrical headlight is for entertainment purposes only, not sufficient for illumination in darkness!
- Do not turn sharply! Make sure the child can use the handlebar properly to direct the product!
- Always wear sneakers or shoes with rubber soles and which completely covers feet!
- Do not ride in wet weather or on wet slippery surfaces!
- Periodically re-check all fasteners to make sure they are tight!
- The Adjustment Tool should only be used by Adult to adjust this product as directed.
- Adjustment Tool is not a toy! Keep Adjustment Tool away from your Child!

 **Always wear a bicycle helmet that complies with U.S. CPSC**

 **CAUTION:**
Please keep small parts, hardware and plastic bags out of children's reach.

Please keep this Owner's Manual for future reference. If you sell or give this product to someone, please include the plastic pouch containing, Owner's Manual and Adjusting Tool, and ask the new owner to read the instructions completely before operating.

Please read this owner's Manual completely before operating this product. All parts are wrapped to prevent damage during shipment. Remove all packing materials from the product prior to operating. After adjusting the saddle and handlebar using the Adjustment Tool, place the Adjustment Tool back to the pouch for future use. Refer to the Parts List and Diagram on page 2 of this manual to make sure all parts are accounted for.

Note: Information contained in Owners Manual may be changed or updated. Please visit our website listed below:

MORGAN CYCLE LLC
Union, New Jersey 07083
www.morgancycle.com
1-973-218-9233

ASSEMBLY INSTRUCTIONS FOR MORGAN RETRO TRICYCLE

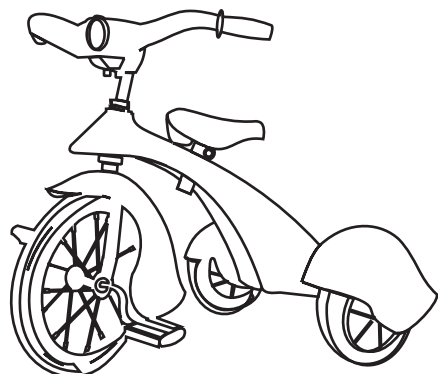

This is how your new Morgan Retro Tricycle should look when completed

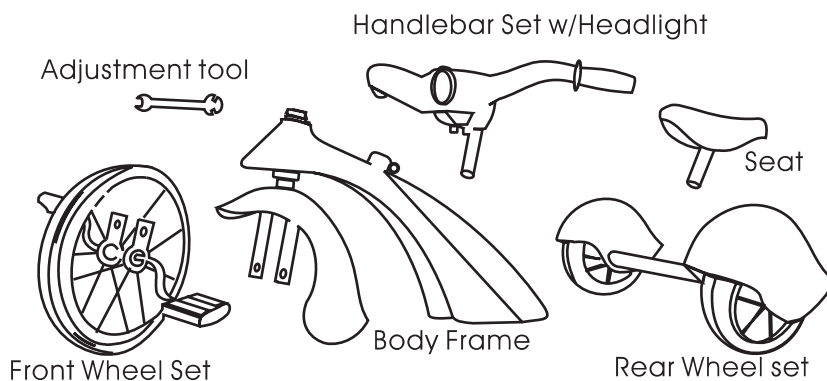

Your new Morgan Retro Tricycle carton should contain the above 5 pieces and Adjustment Tool

Follow the 4 Step instructions below, in order from 1 to 4

3. Insert Handlebar Set to desired level.

WARNING:
MAKE SURE "MINIMUM INSERT" MARK ON POST IS NOT EXPOSED

- a) Tighten the Post Head Nut, which is located at top of the steering column post. Tighten in clockwise motion.

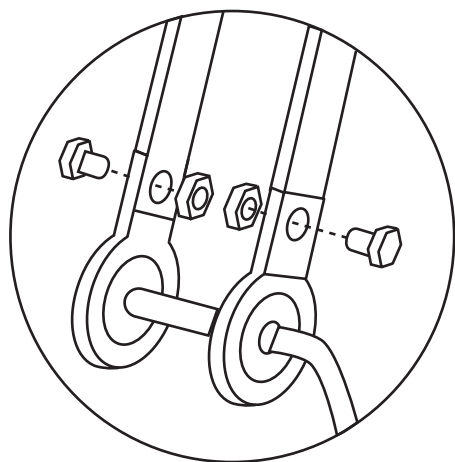

2. Attach Front Wheel Fork

- a) Start by removing Bolt from both brackets of front wheel.
b) Slide the brackets over the fork, **BE SURE THE HOLES LINE UP**
c) Insert the bolts into the bracket holes.
d) Tighten the bolt to secure Front wheel Set to Fork.

4. Insert the Seat Post to desired level.

Tighten the seat post clamp nut in clockwise motion.

WARNING:
MAKE SURE "MINIMUM INSERT" MARK ON POST IS NOT EXPOSED

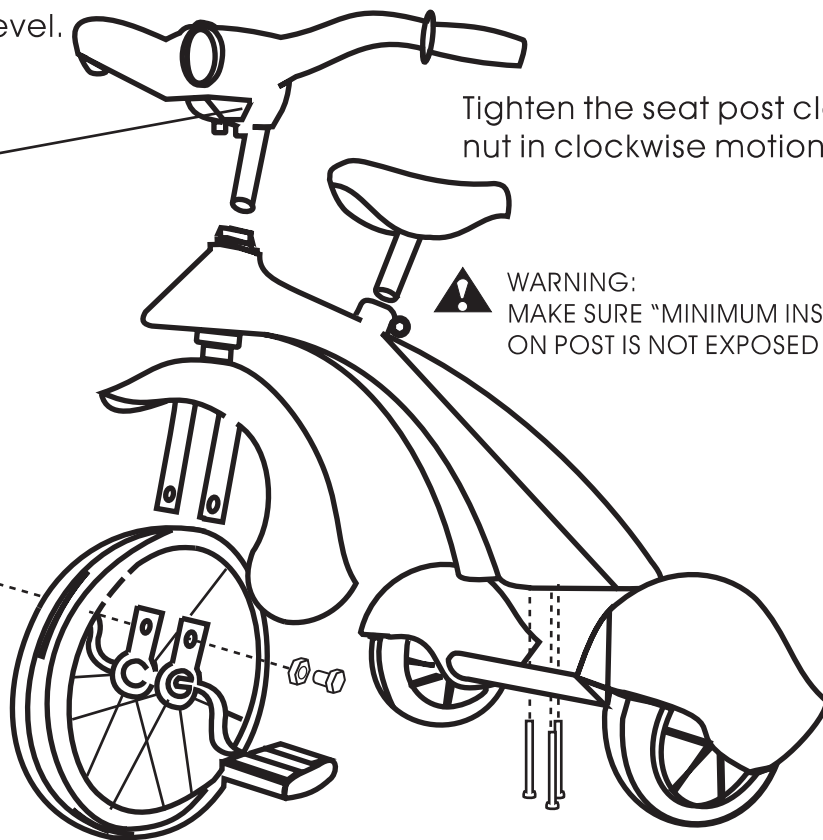

1. Attach the Rear Wheel Set

- to underside of Body Frame.
a) Start by removing the 3 bolts located underside of Body Frame.
b) Line up the 3 pre-drilled holes on Rear Wheel Set to 3 holes on Body Frame.
c) Thread the 3 bolts through the holes and tighten clockwise.

Morgan Retro Tricycle by MorganCycle.com

If any parts are missing/damaged, or you have any questions, please contact Customer Service:

email: help@morgancycle.com phone: (973) 960-2688

- 1) Ride-on toys should not be used near swimming pools, on or near steps, hills, roadways, on wet slippery or rough terrain, on inclines, near stairways, around moving or parked cars.
- 2) This play vehicle is not equipped with a braking device.
- 3) Instruct child not to ride double. A second child could cause the unit to tip over. Instruct the rider not to carry anything on the unit that could interfere with his vision or operation.
- 4) Rider is required to wear a properly fitted CPSC bicycle helmet when operating this vehicle. Children should always wear shoes when riding this vehicle. The rider should never place their hands or feet near moving parts while the unit is being operated.
- 5) Never leave child unattended with this product. Parental or guardian supervision is required at all times.

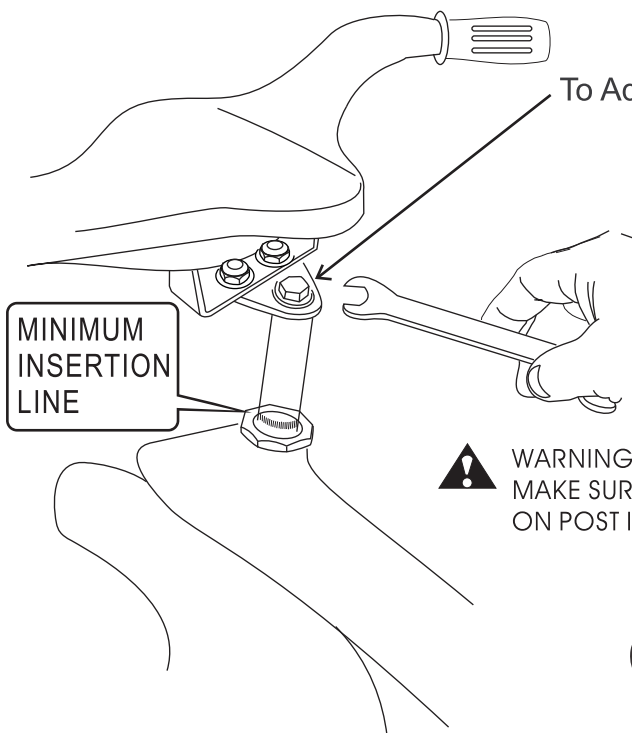

To Adjust Handlebar Height: use wrench to loosen Top bolt (turn Counter-Clockwise).
Raise/lower Handlebar to desired height.
Use wrench to tighten Top bolt (turn Clockwise).

Tool Required for Assembly :
8" Adjustable Wrench

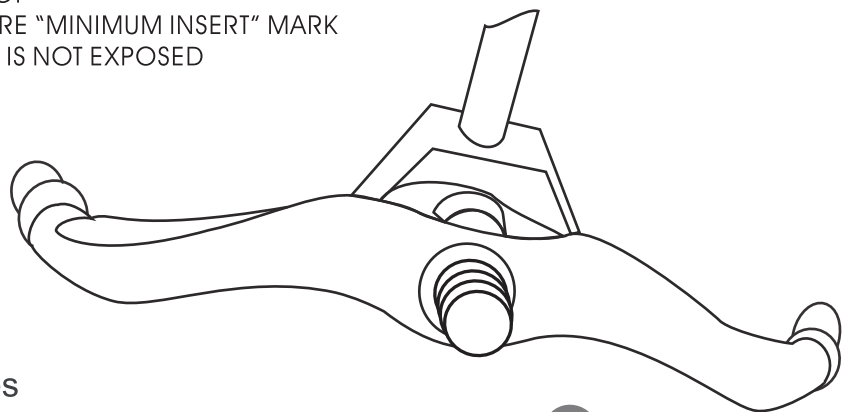

To Replace / Insert Batteries

- 1) Loosen Headlight Cover by twisting Counter-Clockwise direction.
- 2) Take Battery Cartridge out, and replace batteries. Note: battery + - polarity direction.
- 3) Insert Cartridge and attached Headlight Cover by turning Clockwise.

Battery Cartridge →  3 X 1.5V
AAA size

Knob side faces OUT

Headlight Cover → 

⚠️ Adult adjusting required!

⚠️ CAUTION:

Do not attempt to adjust the tricycle unless you know the proper procedures. If you are uncertain of procedures, bring the manual and tricycle to your local bicycle repair professional.

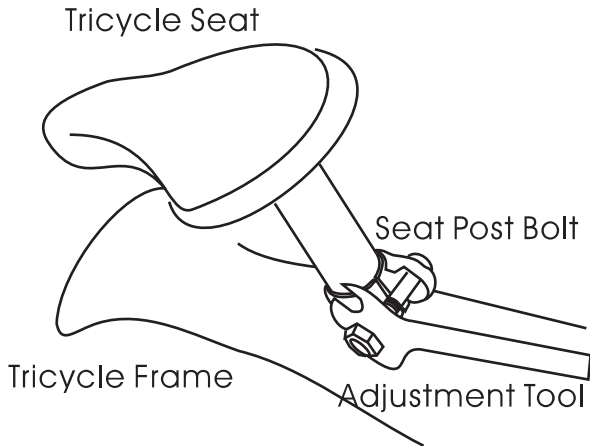

CAUTION: Avoid scratching Tricycle body when using Adjustment tool!

Adjusting the Seat Height

⚠️ Warning:

The seat post "MINIMUM INSERTION" line must be completely inserted into the frame and **NOT** be visible.

1. Using the Adjustment Tool, loosen the Seat Post Nut and Bolt by turning in counter-clockwise direction.
2. Using a twisting motion, raise or lower the Seat to desired height. CAUTION: The maximum Seat height will expose 2.5 inches of the Seat Post. Do not raise Seat Post to reveal the "MINIMUM INSERTION" line marked on Seat Post.
3. With the Seat facing forward, use the Adjustment Tool to securely tighten the Seat Post Nut and Bolt. Make sure the Seat does not spin or move up or down.

Adjusting the Handlebar Height

⚠️ Warning:

Handlebar post "MINIMUM INSERTION" line must be completely inserted into the frame and **NOT** be visible.

1. Locate the Handlebar Post Bolt, which is situated on top of Handlebar Post and below the rear of Light.
2. Using the Adjustment Tool, loosen the Handlebar Post Bolt by turning in counter-clockwise direction.
3. Using a twisting motion, raise or lower the Handlebar to desired height. CAUTION: The maximum Handlebar height will expose 2.5 inches of the Handlebar Post.
4. With the Handlebar properly positioned, use the Adjustment Tool to securely tighten the Handlebar Post Bolt. Make sure the Handlebar does not spin or move up or down.

